

On Demand Multi-Use Display™

Use the On Demand Multi-Use Display™ to operate the audio system.

Selecting an Audio Source

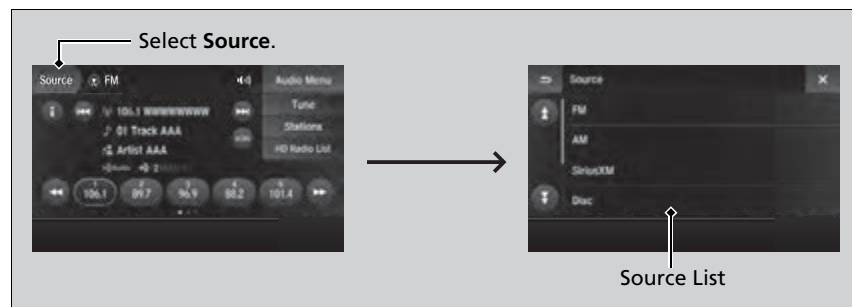



Select **Source**, then select an item on the source list to switch the audio source.

On Demand Multi-Use Display™

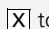
Icons that appear on the screen vary by the source selected.



Select  or  to go back to the previous screen.

Use the / icons to turn the page.

Selecting an Audio Source

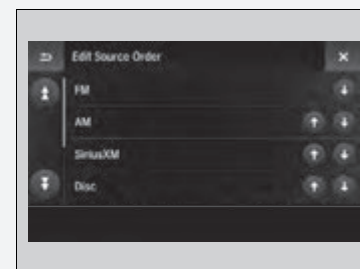
You can change the order of source list displayed.



1. Select **Audio Menu**, then **Edit Source Order**.
2. Select  or .

You can also change the source order by pressing and holding the source on the source list for two seconds.

Continued

■ Displaying the Menu Items

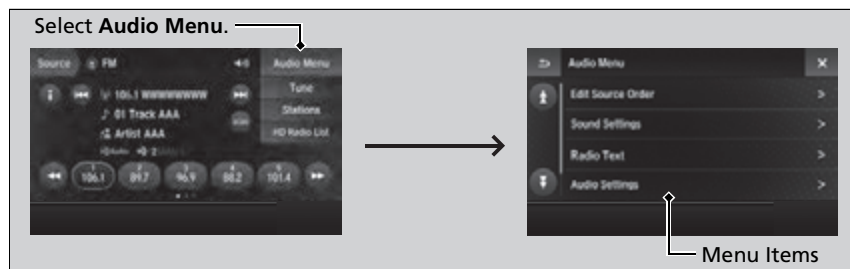

Select **Audio Menu** to display the menu items.

The following items are available:

- **Edit Source Order:** Displays the **Edit Source Order** screen.
 - ▶ Selecting an Audio Source P. 211
- **Sound Settings:** Displays the **Sound Settings** screen.
 - ▶ Adjusting the Sound P. 220
- **Edit/Delete HDD Music (HDD mode)*:** Displays the **Edit/Delete HDD Music** screen.
 - ▶ Editing an Album or Playlist P. 248
- **Radio Text (FM mode):** Displays the text information broadcast by the current RDS station.
 - ▶ Radio text P. 227

* Not available on all models

- **SportsFlash** (SiriusXM® mode): Displays the SportsFlash™ list. If the favorite sport team is not registered, the setup screen of SportsFlash™ is displayed.
 - ▣ **Live Sports Alert** P. 234
 - ▣ **Customized Features** P. 316
- **Traffic & Weather Now** (SiriusXM® mode): Displays the Traffic & Weather Now screen.
 - ▣ **Traffic and Weather Information** P. 236
- **View Channel Schedule** (SiriusXM® mode): Displays the SiriusXM® channel schedule.
- **Audio Settings**: Displays the **Audio Settings** screen.
 - ▣ **Customized Features** P. 316
- **Screen Settings**: Displays the **Screen Settings** screen.
 - ▣ **Changing the Screen Settings** P. 214

■ Changing the Screen Settings

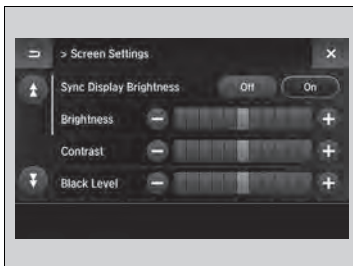

1. Select **Audio Menu**, then select **Screen Settings**.
2. Use **+**, **-** or other icons to adjust the setting.

» Changing the Screen Settings

The following are adjustable screen settings:

- **Sync Display Brightness**
Selects whether the screen brightness synchronizes with the instruments panel brightness.
- **Brightness**
- **Contrast**
- **Black Level**
- **Beep**
Mutes a beep that sounds every time you touch the screen.
- **Keyboard**
Changes the on-screen keyboard from the alphabetical order to the qwerty type.

Instead of using **+**, **-** or icons, you can also touch the point where your desired setting is.