

VEHICLE CONTROLS

Various controls necessary for operating and driving the vehicle.

Using the Remote Transmitter

Lock or unlock the doors or trunk.

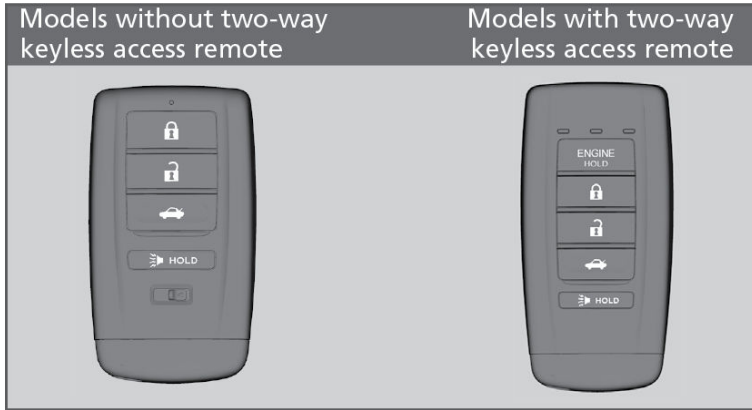

NOTICE

Leaving the remote transmitter in the vehicle can result in theft or accidental movement of the vehicle. Always take it with you whenever you leave the vehicle unattended.

Keyless Access System

When you carry the remote transmitter, in a pocket or purse and it is outside the vehicle and within range (about 32 inches or 80 cm), you can lock or unlock the doors, and open the trunk without handling the transmitter.

■ Unlocking/Locking the Doors

To unlock: Grab the driver's door handle to unlock the driver's door. Grab the front passenger's door handle or rear *1 door handle to unlock all the doors. You can customize this feature's behavior.

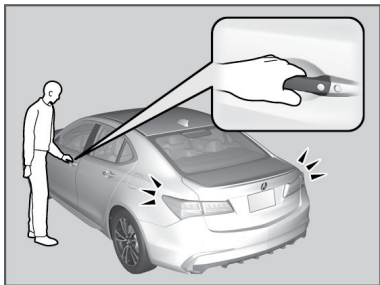

*1 - If equipped

To lock: Press the door lock button on either front door or rear*¹ door handle when the vehicle is off. If the remote transmitter is inside the vehicle, the doors will not lock.

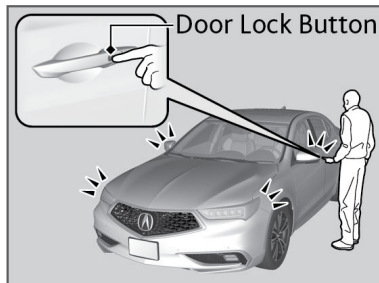

Note: System range is affected by radio signals from other devices (for example, cell phones or tablets) so for best results, carry the remote transmitter separately from these devices.

■ Customizing Door Lock and Unlock Settings

Customize the auto door lock and door unlock settings to your preference.

Models with Information Screen

Make sure that the vehicle is at a complete stop and the transmission is put into Park (P).

1. Press the **SETTINGS** button, then select **Vehicle Settings**.
2. Rotate interface dial, then select **Door**.
3. Rotate interface dial, then select **Auto Door Lock** or **Auto Door Unlock** and push **ENTER** button.

**1 - If equipped*

■ Walk Away Auto Lock®

When you walk away from the vehicle while carrying the remote transmitter, the doors and trunk can automatically lock if the following conditions are met:

- The remote transmitter is within a range of 5 feet (1.5 m).
- All doors and the trunk are closed.
- There is not an additional remote transmitter inside the vehicle.

Follow these steps:

1. Exit the vehicle, close the door and stay near it. Listen for a beep. The system is activated.
2. Walk at least 5 feet (1.5 m) away.
3. Listen for a beep and look for the lights to flash. The doors lock.

The auto lock function is set to OFF as the factory default setting. It can be set to ON using the information screen or multi-information display screen. If you set the auto lock function to ON, only the remote transmitter that was used to unlock the driver's door prior to the setting change can activate auto lock. To turn on this feature, follow the steps below:

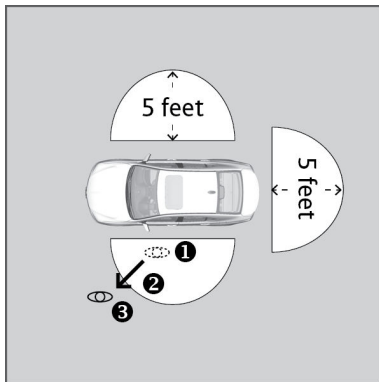

Models with Information Screen

1. Press the **Settings** button, then select **Vehicle Settings**.
2. Select **Keyless Access**.
3. Select **Walk Away Auto Lock®**, then select **ON**.