

Personal Settings

Storing a Driving Position in Memory

Memory Buttons

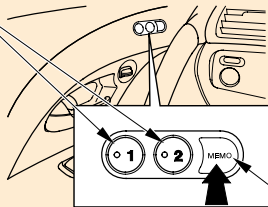

Memo Button

1. Shift to Park.
2. With the ignition ON (II), adjust the seat, steering column and outside mirrors to the desired position.
3. Press and release MEMO. When you hear a beep. The memory button indicators (1 & 2) will blink. Immediately press the desired memory indicator until you hear 2 beeps. The selected memory indicator will stay on.

Selecting a Memorized Position

1. Place the transmission in Park.
2. With the ignition ON (II), press and release the desired MEMORY button (1 or 2).

Personal Settings

Power Seats

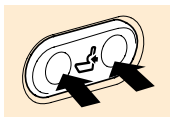
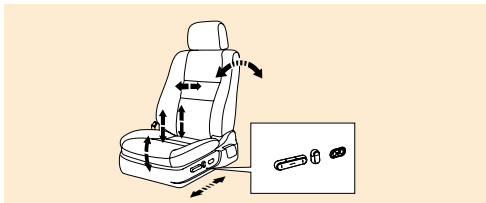

Press either side of the bar to increase or decrease the lumbar support.

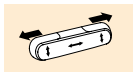

- Moves the seat forward and backward.

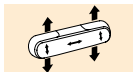

- Moves the front of the seat up or down, and the rear of the seat up or down.

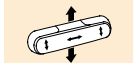

- Raises or lowers the seat.



- Adjusts the seat-back angle forward or backward.