



Over the Air System Updates

May 13, 2020

2019-20 RDX Adding Android Auto App Icon To the Home Screen

INTRODUCTION

The latest software adds Android Auto App to the system.

TO ADD ANDROID AUTO APP ICON TO THE HOME SCREEN AND THE HEAD-UP DISPLAY

NOTE: Not available for all models.

1. Select the Home button on the touch pad to get to the Main Home screen.

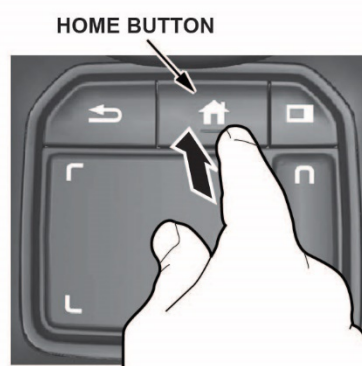
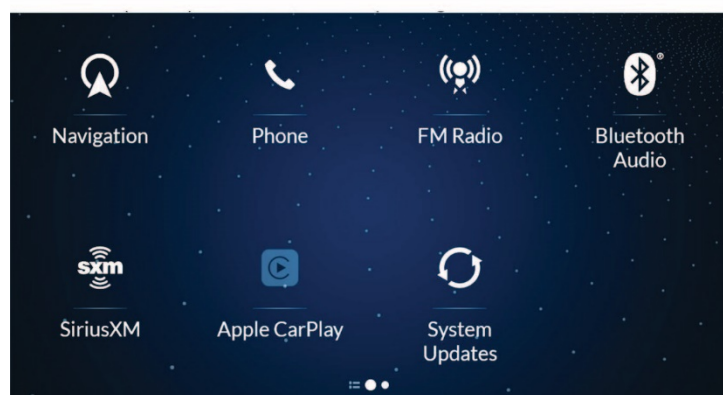

2. Swipe right on True Touchpad A to display the All Apps screen.

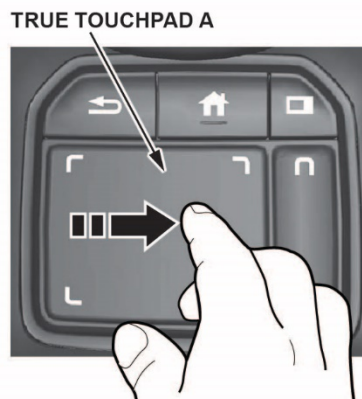
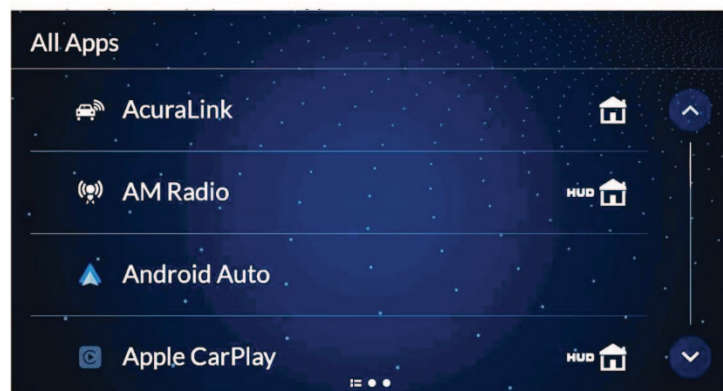

3. Go to the Android Auto app on the list, then press and hold True Touchpad A.

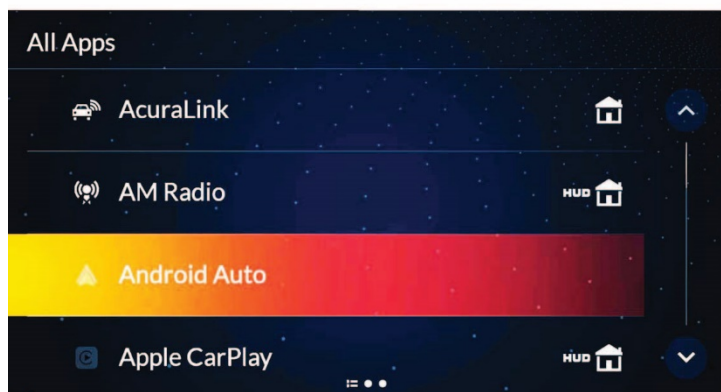

4. From the pop-up menu, select **Add to Home Page** or **Add to Heads-Up Display**.

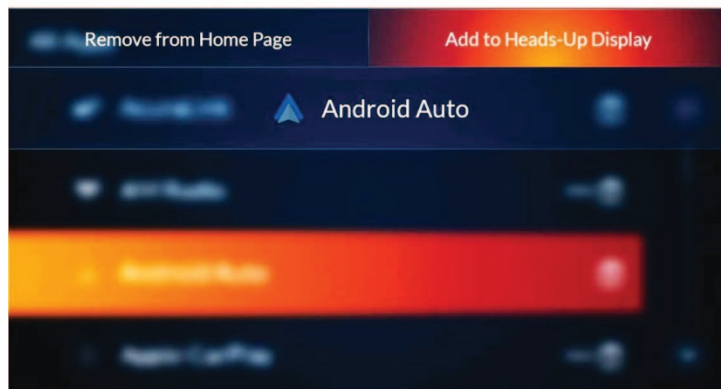
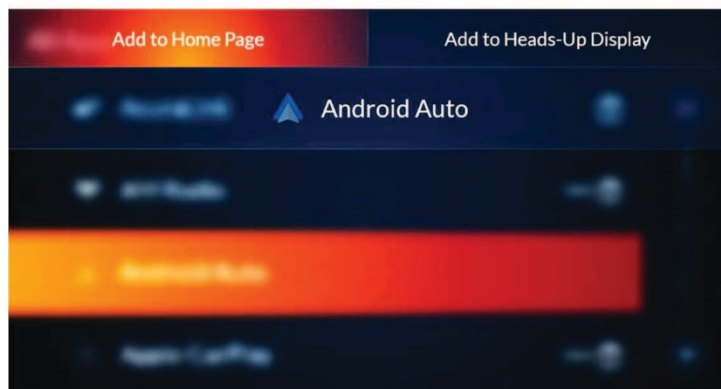

The HOME icon or HUD appears next to the app on the list when the corresponding icon has been added to the home screen or head-up display.

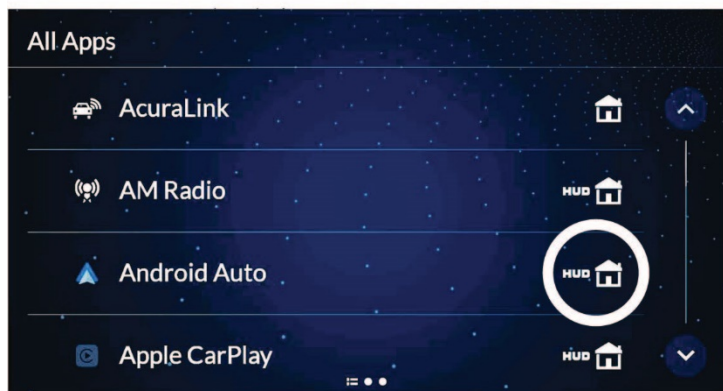

TO MOVE THE ANDROID AUTO APP ICON TO SHOW ON THE MAIN SCREEN.

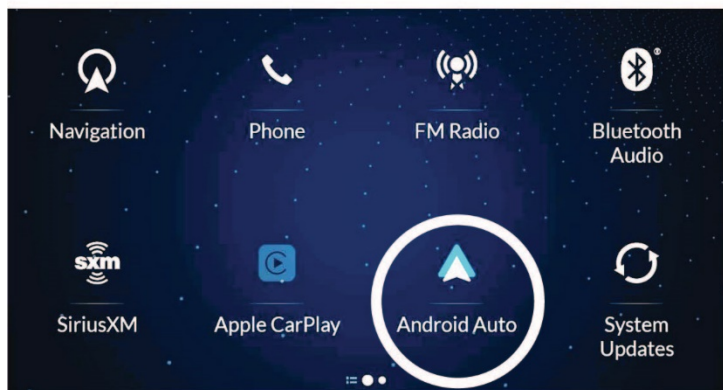

1. Select the Android Auto icon then press and hold True Touchpad A.

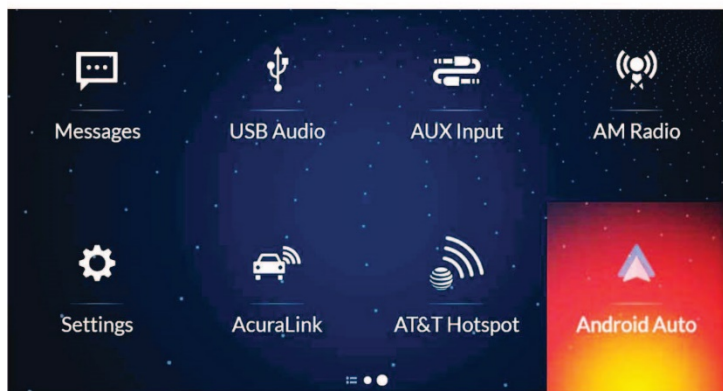

TRUE TOUCHPAD A



2. The screen will change to the customization screen.

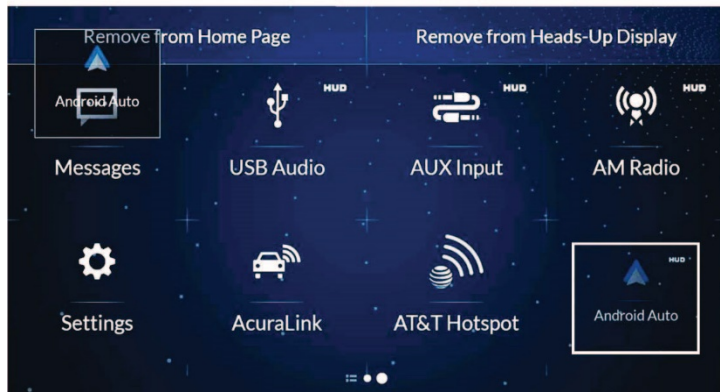

3. Drag the Android Auto icon to where you want it to be and then press and hold the True Touchpad A.

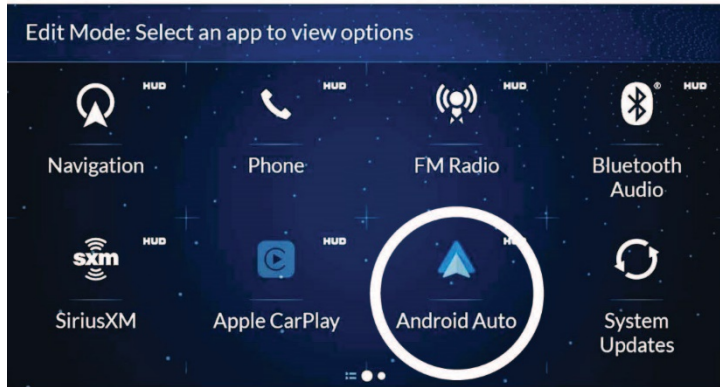
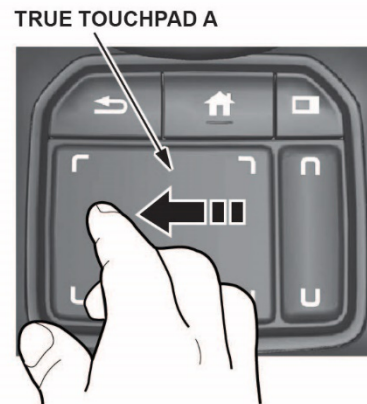
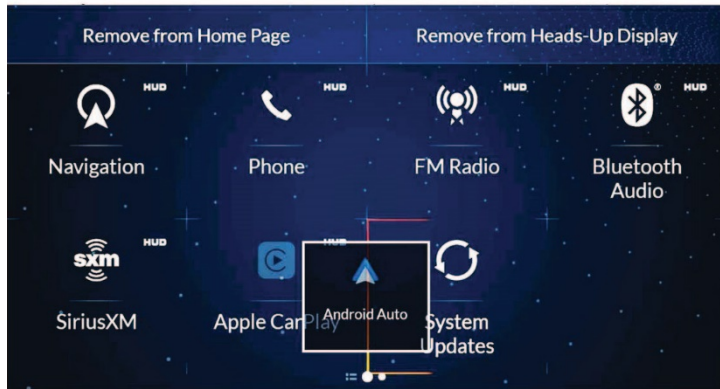

- The icon will be repositioned and the screen will remain in the customization mode.
- After you drag the icon, keep your finger on the True Touchpad A and then press down. If you release your finger before pressing the True Touchpad A, the icon will remain in its original place.
- If you want to reposition the icon on another page of the home screen, swipe the True Touchpad A.

4. Press the back button or the Home button to confirm the change.

