

■ Audio Remote Controls

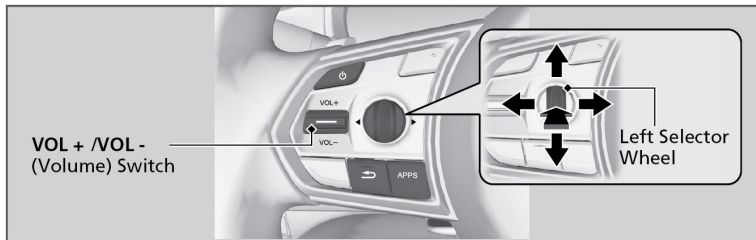

Volume Switch (+/-): Press to adjust the volume.

Left Selector Wheel: Roll up/down to cycle through the available audio modes.

■ Adjusting the Sound

Adjust various sound settings.

USB Audio and AUX Input Mode

1. Press the Home button.

2. Select an audio source icon.
3. Select **SOUND**.
4. Select the setting you want.

FM Radio, AM Radio, Sirius XM, and *Bluetooth*[®] Audio Mode

1. Press the Home button.
2. Select an audio source icon.
3. Select **Menu**.
4. Select **Sound Settings**.
5. Select the setting you want.

FM/AM Radio

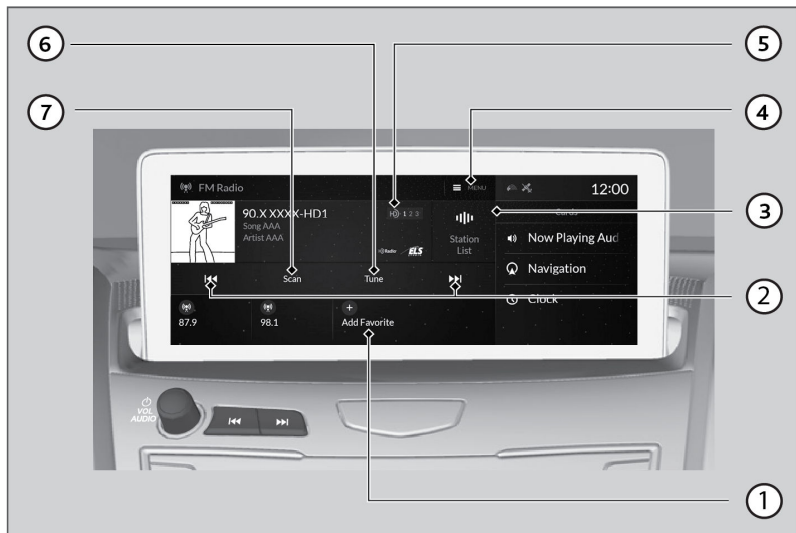

- Favorite Station Icons, Add Favorite** - Tune the radio frequency for favorite station. Select Add Favorite to store the station. Swipe left or right on the true touchpad A to display the next or previous favorite station list.
- Tune Up/Down Icons** - Select to search up and down the selected band for a station with a strong signal.
- Station List** - Select to display the station list screen.
- MENU** - Select to display the station list screen.
- HD icon** - Select to display the subchannel list screen.
- Tune** - Select to display the manual input screen of radio frequency.
- Scan** - Select to sample each of the strongest stations on the selected band for 10 seconds.

SiriusXM® *1

Available on a subscription basis only. For more information or to subscribe, contact your dealer, or visit www.sirius.com/subscribenow (U.S.) or www.sirius.ca/subscribe-now (Canada).



- (Seek/Skip) Buttons** - Press to switch to the previous or next channel. Press and hold to rapidly skip 10 channels at a time.
- Category Icons** - Select to change the category.
- Channels** - Select to display the channel list screen.
- MENU** - Select to display the Menu screen.
- Channel Up/Down Icons** - Select for the previous or next channel.
- Album Art**
- Favorite Channel Icons, Add Favorite** - Tune the channel for favorite channel. Select Add Favorite to store the channel. Swipe left or right on true touchpad A to display the next or previous favorite channel.

*1 - If equipped

Bluetooth® Audio

Play audio from your compatible phone when it is paired to *Bluetooth®* HandsFreeLink® (see Pairing a Phone). Visit handsfreelink.com (US) to check phone compatibility. Canada customers can phone (855) 490-7351 for any HandsFreeLink® related inquiry.

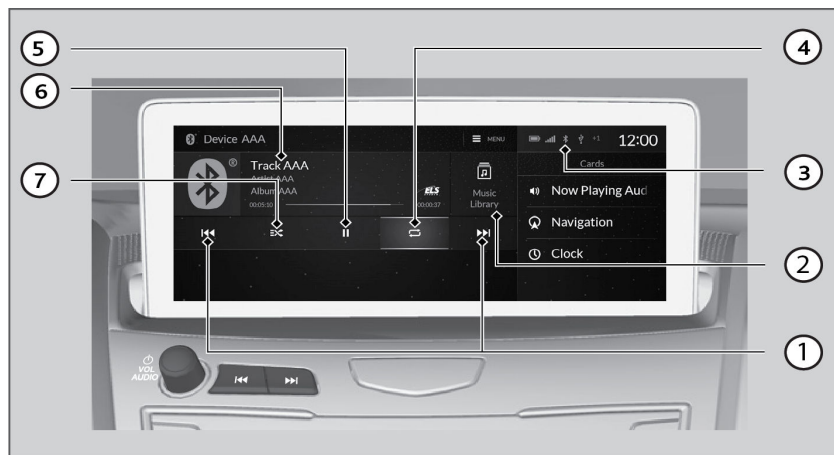

1. **Track Icons** - Select to change tracks. Select and hold to move rapidly within a track.
2. **Music Library** - Select to display the music search screen.
3. **Bluetooth® Indicator** - Appears when your phone is connected to HFL.
4. **Repeat Icon** - Select to repeat the current file.
5. **Play/Pause Icon**
6. **Current Track Information** - Select to display the play list screen.
7. **Random Icon** - Select to play all files in the current folder in random order.

■ Searching for Music

Applicable laws may prohibit the operation of handheld electronic devices while operating a vehicle. Launch streaming audio on your phone only when safe to do so.

AUDIO AND CONNECTIVITY

1. Select Music Library.
2. Select a search category (e.g., Albums).
3. Select an item.

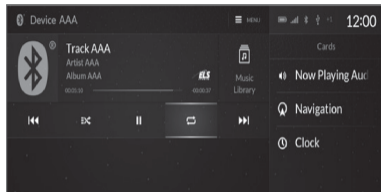

Note:

- Make sure the volume on your phone is properly adjusted.
- You may need to enable additional settings on your phone for playback.
- The resume/pause function and remote audio controls are not supported on all phones.