

AUDIO AND CONNECTIVITY

Learn how to operate the vehicle's audio system.

Basic Audio Operation

Connect audio devices and operate buttons and displays for the audio system.

■ USB Ports

The center console has three USB ports. All of them can charge a device. Connect an audio device to the right-hand port for audio playback.

1. Slide back the center console cover. Open a USB port cover.
2. Install the device to charge or for playback.

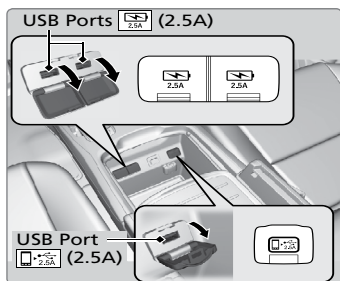

The back of the second-row console* has two USB ports. They are for charging devices.

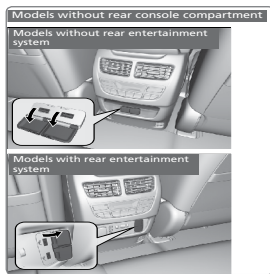
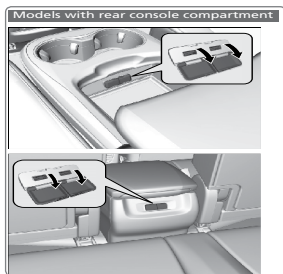

■ Auxiliary Input Jack

Connect standard audio devices with a 1/8-inch (3.5 mm) stereo miniplug.

1. Slide back the center console cover. Open the AUX cover.
2. Connect the device to the input jack.
3. Use the device to control the audio.

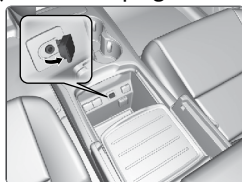

**if equipped.*

Applicable laws may prohibit the operation of handheld electronic devices while operating a vehicle.

■ Accessory Power

12-volt outlets are in the front pocket and rear cargo area. Open the socket cover to use power when the vehicle is on.

An outlet in the center console is either a 150-watt AC-power outlet or an additional 12-volt outlet, depending on the vehicle.

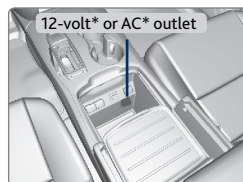

NOTICE

Do not insert an automotive type cigarette lighter element. This can overheat the power socket.

■ Steering Wheel Controls

Operate certain functions of the audio system using the steering wheel controls.

Left selector wheel: Roll up or down to adjust volume. Press to mute. Move (or hold) left or right to change stations or tracks.

SOURCE button: Cycle through available audio modes.

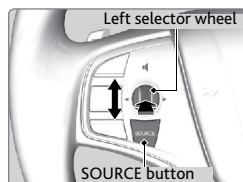

FM/AM/SiriusXM® Radio

Move right or left for the next or previous station. Move and hold right or left to scan the next or previous strong station.

CD/HDD*/iPod*/USB/Bluetooth® Audio

Move right or left for the next or previous track. Move and hold right or left for the next or previous folder (CD/HDD*/USB).

Pandora®*/Aha™

Move right for the next song. Move and hold right or left for the next or previous station.

■ Adjusting the Sound

Adjust various sound settings. Use the interface dial to make and enter selections.

1. Press MENU.
2. Select Sound.
3. Select the sound setting to adjust.
4. Adjust the setting to the desired level.
5. Press BACK to exit the menu.



**if equipped*

■ On-Demand Multi-Use Display (ODMD) and Controls

Operate the audio system using either the touchscreen or dashboard buttons.

The functions shown here can be used with most audio sources. Refer to subsequent audio pages for more specific functions. Options that appear depend on the selected audio source.

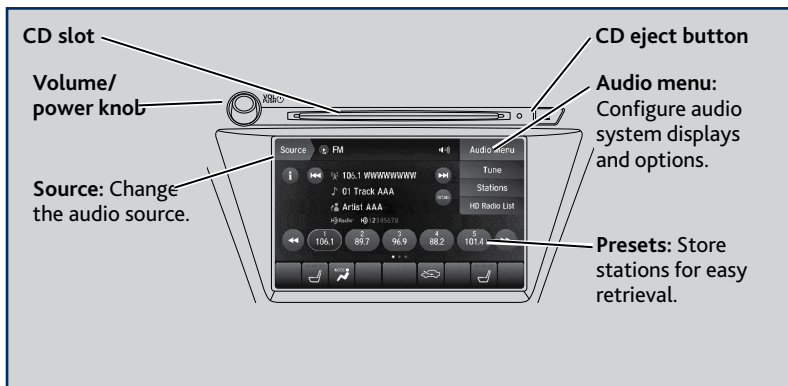

Audio buttons



**if equipped*

FM/AM Radio

Play FM or AM radio stations.

Source: Select the FM or AM icon.

Information: Show information about the current station.

Presets: To store a station, tune to the desired station, select Presets, and select and hold the desired preset number. Select a preset station once stored.



Tune: Manually change the station.

Stations: Show the station list screen.

Skip/seek: Find a station with a strong signal.

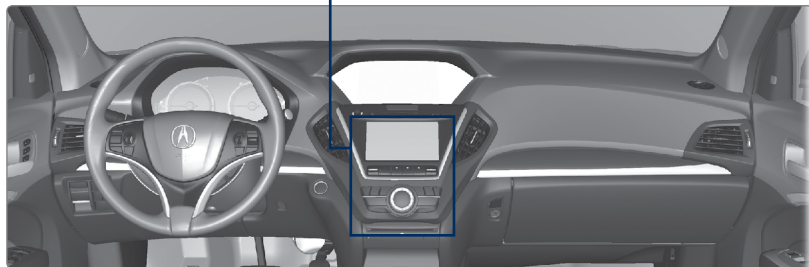
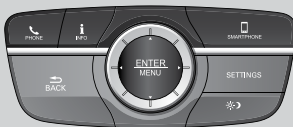

SiriusXM® Radio

Available on a subscription basis only. For more information or to subscribe, contact your dealer or visit www.siriusxm.com/subscribenow (U.S.) or www.siriusxm.ca/subscribe-now (Canada).

Source: Select the SXM icon.

Category row: Use arrows to select a category.

Channel row: Use arrows to select a channel within the category.

Browse: Show list of categories or channels.

Tune: Manually select a channel.

Presets/Controls: View replay controls.

Presets: To store the current station, select and hold the desired preset number.

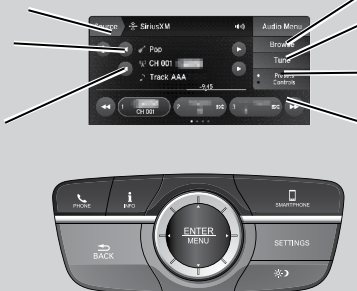

The diagram illustrates the SiriusXM interface and physical controls. The top part shows a screen with a 'Source' button (labeled 'SXM'), a 'Category row' with arrows, a 'Channel row' with arrows, and a 'Browse' button. The bottom part shows a physical control panel with a central 'ENTER MENU' button, 'BACK', 'PHONE', 'INFO', 'SMARTPHONE', 'SETTINGS', and 'PRESETS' buttons. Arrows point from the text labels to the corresponding elements in the interface and physical controls.



Available in the U.S. and Canada, except Hawaii, Alaska, and Puerto Rico.

XM® is a registered trademark of Sirius XM Radio, Inc.

Compact Disc (CD)

The audio system supports audio CDs, CD-Rs, and CD-RWs in MP3, WMA, or AAC formats.

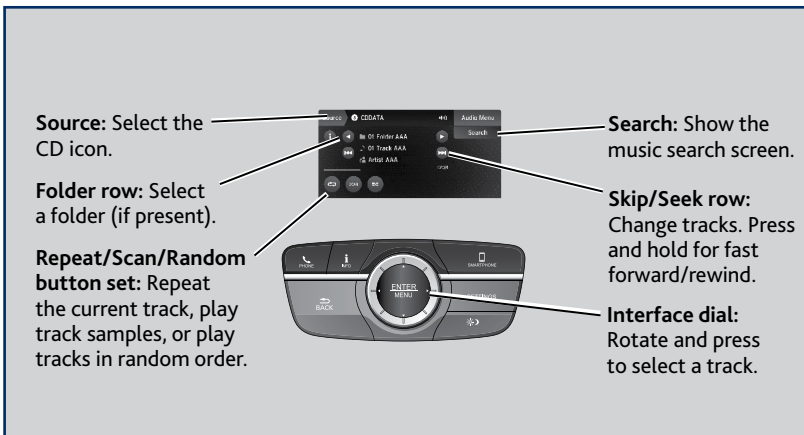

NOTICE

Do not use CDs with adhesive labels or insert a damaged CD. Inserting these types of CDs may cause them to get stuck inside or damage the audio unit.

USB Flash Drive

Connect your device to the USB port.

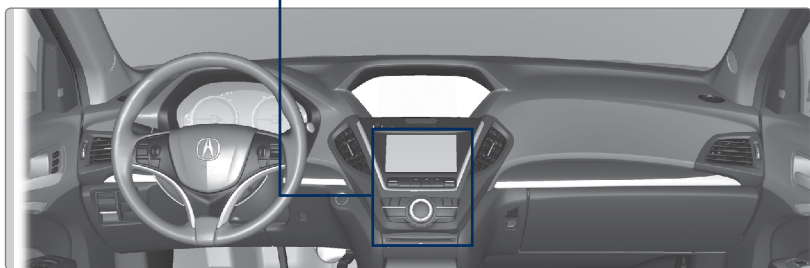
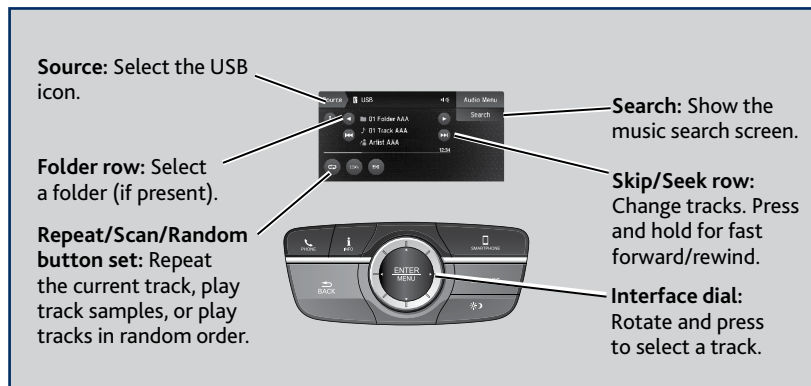

■ Searching for Music

Use the touchscreen to search for tracks.

1. From the audio screen, select Search.
2. Select a folder.
3. Select the song you want to play.

On vehicles with navigation, you can also search for and play iPod music using Song By Voice™.

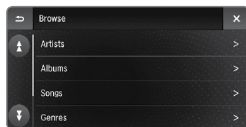



Connect your iPod to the USB port.

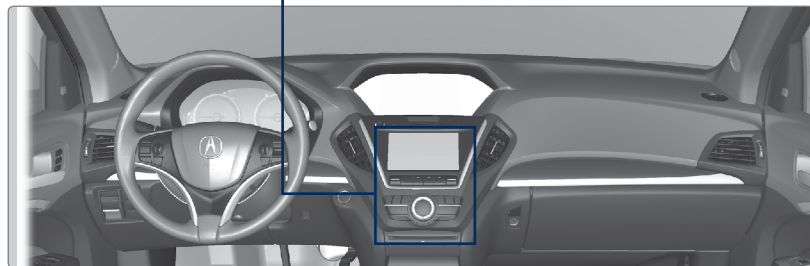
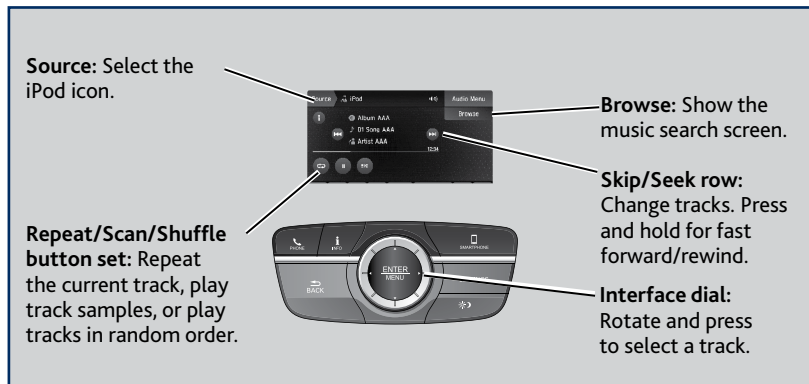

■ Searching for Music

Use the touchscreen to search for tracks.

1. From the audio screen, select Browse.
2. Select a category.
3. Select the song you want to play.

On vehicles with navigation, you can also search for and play iPod music using Song By Voice™.

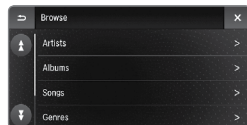

Bluetooth® Audio

Play streaming or stored audio from your compatible phone when it is paired to **Bluetooth® HandsFreeLink®** (see page 96). Visit www.handsfreelink.com/Acura (U.S.) or phone (888) 528-7876 (U.S. and Canada) to check phone compatibility. Standard data rates may apply.

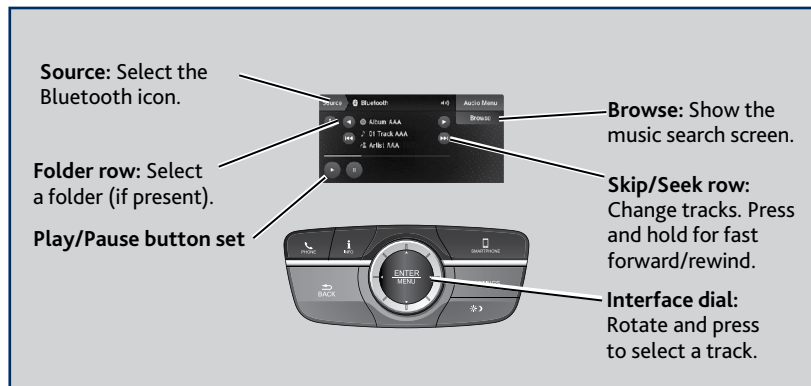

Notes:

- Make sure the volume on your phone is properly adjusted.
- You may need to enable additional settings on your phone for playback.
- The resume/pause function and remote audio controls are not supported on all phones.

*Applicable laws may prohibit the operation of handheld electronic devices while operating a vehicle.
Launch streaming audio on your phone only when safe to do so.*

Hard Disc Drive (HDD) Audio

When music CDs are inserted, they are automatically recorded by system default onto the built-in HDD for later playback.

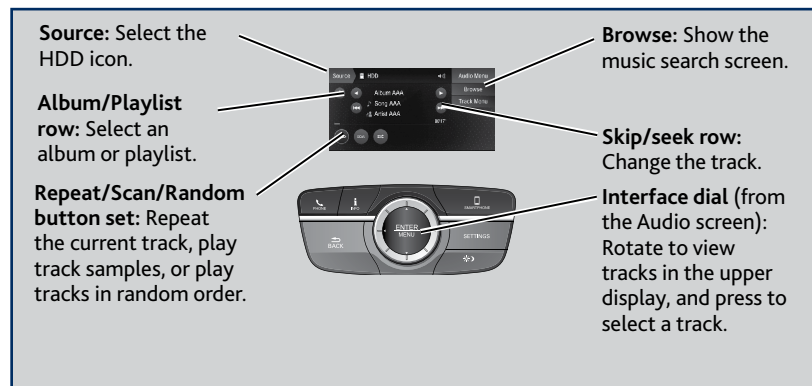

■ Searching for Music

Use the interface dial to search for tracks using several methods.

1. From the audio screen, select Browse.
2. Select a search type (artist, album, track, etc.).
3. Select the song you want to play.

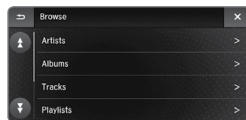

You can also search for and play HDD music using Song By Voice™.